

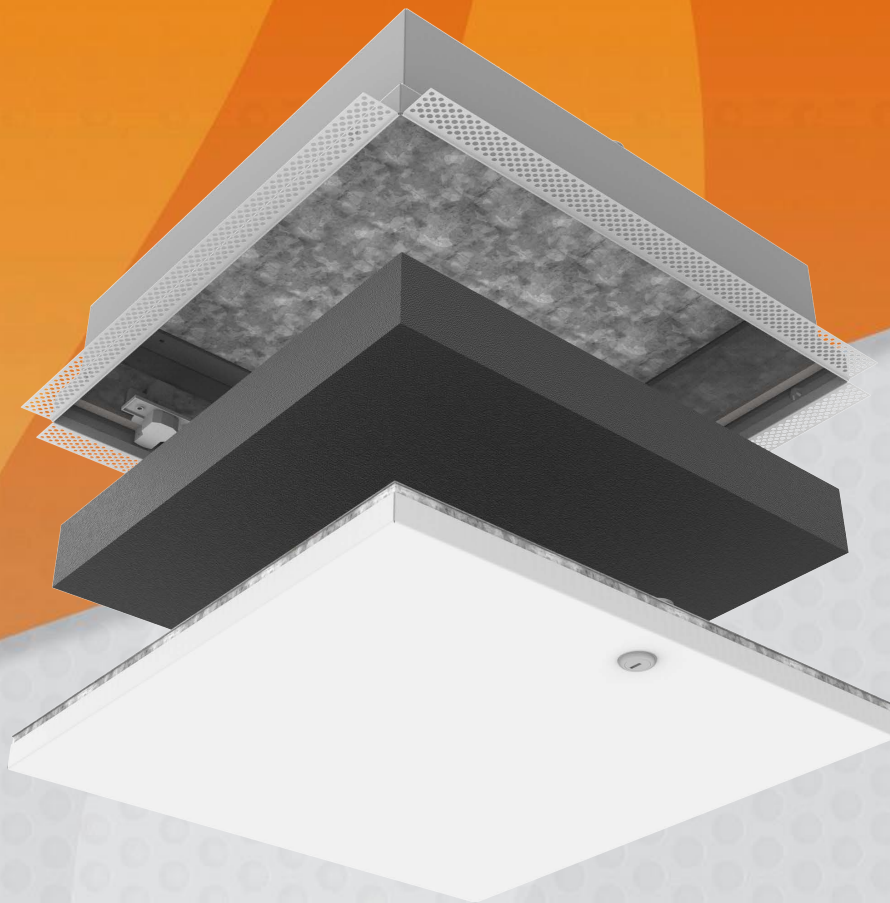

ACOUSTIC

METAL ACCESS PANELS (Rw51)



Trafalgar has the most extensive range of access panels available:

Small Sizes | Large Sizes | Custom Sizes
Tileable | Security | Acoustic | Fire Rated
Stainless Steel | Upward Opening | MDF
Touch Latch | Customwood | Service Shaft

ACOUSTIC

Metal Access Panels (Rw51)

Technical Specifications

Trafalgar Rw51 Metal Acoustic Access Panels are manufactured in Australia and have been designed for use where there is a noise transmission issue. They are used where convenient access is required into walls and ceilings where an acoustic rating is necessary. Trafalgar Rw51 panels have been independently approved and achieve a superior rating of Rw51 in suitable openings.

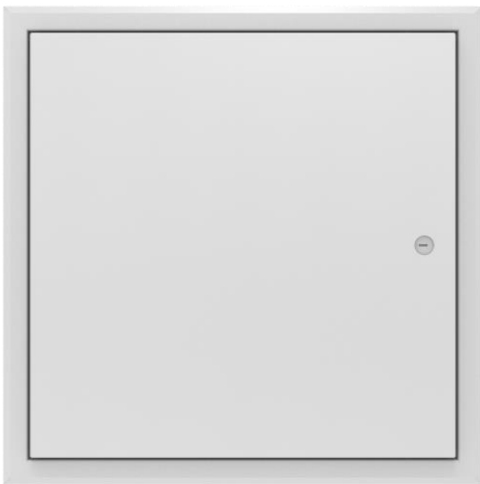

Acoustic Rating:
Rw 51 +/-3db

These panels are constructed using two metal / MDF acoustic doors, steel frame and concealed cupboard hinges. They are secured with a key lock as standard.

When installed, Trafalgar Rw51 panels sit flush with the surface leaving a neat opening around the perimeter.

All Rw51 panels are manufactured to order.

Access panels are typically installed during construction, but they can also be retro-fitted when additional access is required.

Key Benefits

- High performance sound containment properties – Acoustic Rating Rw 51
- Compact functional design
- Simple installation
- Available in wet wall (set bead) or flanged edge frame
- Key lock option available
- For use in a wide range of applications where noise transmission needs to be minimised, including hotels, education, government, medical, offices, residential and commercial buildings
- Australian Made
- Custom made to any size up to 600x600

ACOUSTIC

Metal Access Panels (Rw51)

Technical Specifications

PRODUCT DESCRIPTION

Rating Rw 54 (+/- 3db)

Door Panel Pre-primed metal coated MDF acoustic panel with acoustic seals and internal sound-foam. Secondary door MDF encased steel door at rear. Safety chain fitted as required.

Frame Pre-primed steel. White as standard. Grey frame optional. Stainless steel frame optional.

Frame Depth 118mm

Cut-Out Size Cut out a hole in the ceiling or wall the same size as the access panel. For example, a 450x450 access panel will have a 450x450 cut out.

Frame Types Flanged Edge (FE) or Wet Wall (WW)

Hinge Concealed cupboard hinges, with the rear door on a concealed piano hinge

Lock Key cam lock

Also Available Trafalgar can custom manufacture to meet your specifications. Trafalgar also supply a comprehensive range of fire rated, metal, customwood, security and speciality access panels.

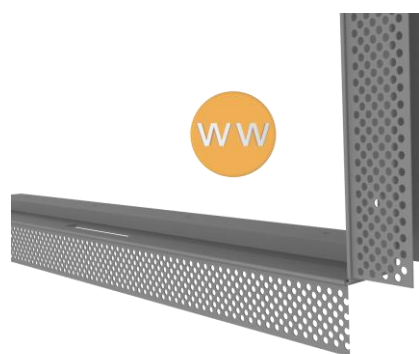

Wet Wall Frame
(Set bead for plastering in)

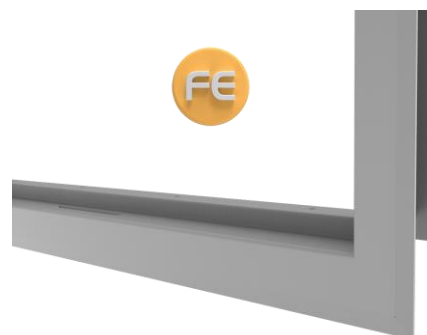

Flanged Edge Frame
(Architrave / picture frame)

ACOUSTIC

Metal Access Panels (Rw51)

Ordering Information

- Locally manufactured in Australia
- Custom made sizes up to 600x600mm
- High performance sound containment properties – Acoustic Rating Rw 54 (+/-3dB)

Rw51M METAL ACOUSTIC ACCESS PANELS

Code	Size (mm)	Weight	Panel	Rating	Frame
Rw51-Custom-FE	300x300	5Kg	Metal Acoustic Panel	Rw 54 ± 3db	Flanged Edge (Architrave)
	450x450	12Kg			
	600x600	21Kg			
Rw51-Custom-WW	300x300	5Kg	Metal Acoustic Panel	Rw 54 ± 3db	Wet Wall (Set bead to plaster in)
	450x450	12Kg			
	600x600	21Kg			

Installation Instructions

1. Mark out and cut an opening in the ceiling or wall to suit the dimensions of the access panel (eg. 450 x 450) taking into account the position of existing joists.
2. The opening must be framed out on all four sides with appropriate wall/ceiling framing to take the weight of the access panel, with the internal aperture lined with two layers of 16mm plasterboard.
3. With front door of the access panel open, remove the acoustic infill material and insert the panel into position. Fix through the provided fixing holes in the frame into the surrounding framework, with fixings as detailed in the drawings below. Replace the acoustic infill when complete.
4. Trafalgar FyreFlex Sealant is required to seal any gaps between the panel frame and wall or ceiling as per the below drawings.

ACOUSTIC

Metal Access Panels (Rw51)

Installation Instructions

Rw51 - Profile Details

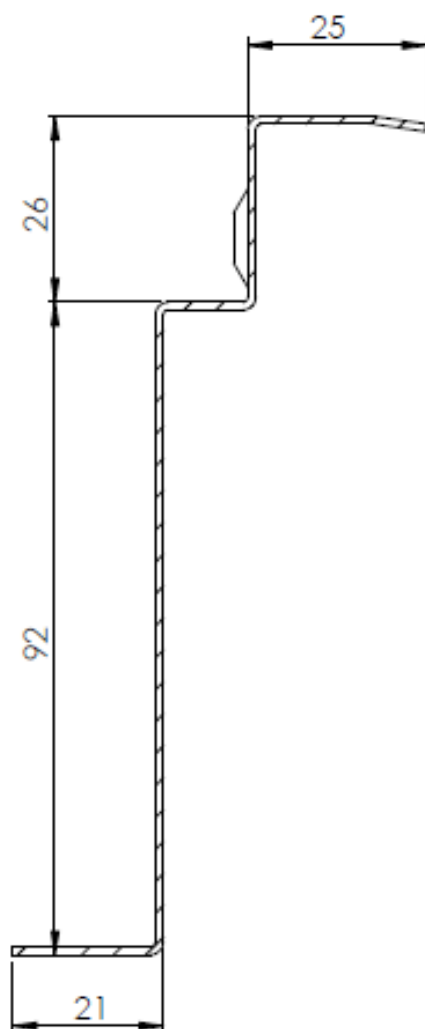

Flanged Edge

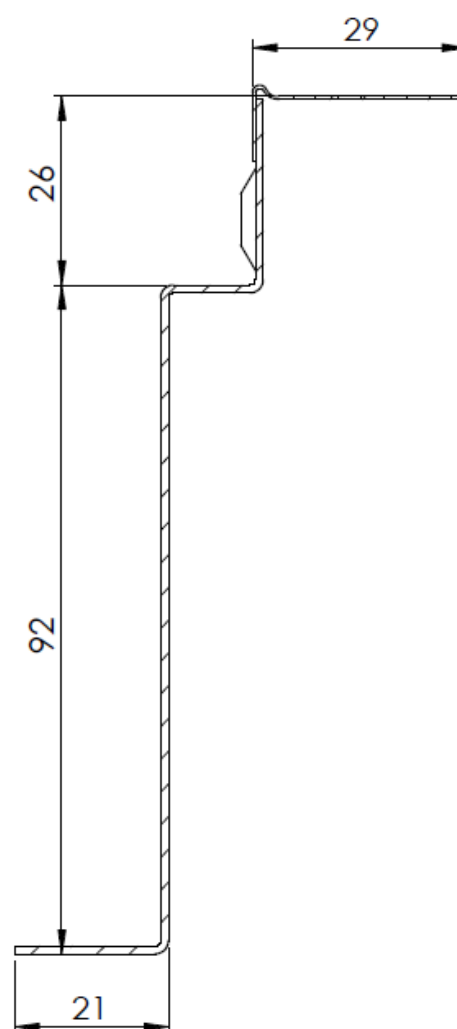

Wet Wall (set bead)

Trafalgar Rw51 Access Panels must be installed into ceilings and walls in positions indicated on the architectural drawings, and in accordance with Trafalgar's installation instructions.

ACOUSTIC

Metal Access Panels (Rw51)

Installation Instructions

Rw51 - Ceiling Installation

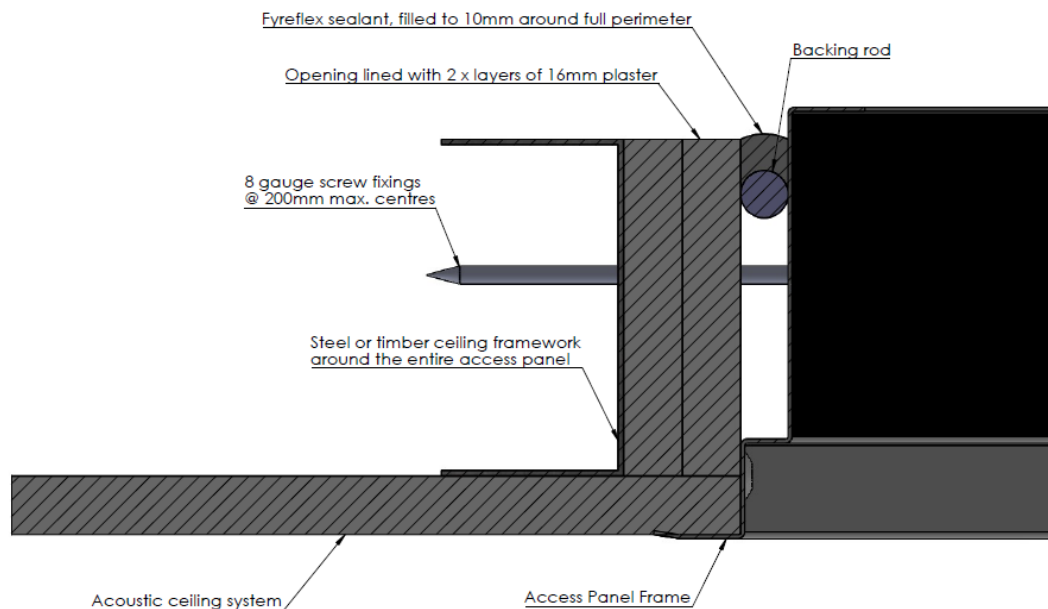

- Ceiling supports not shown for clarity.
- Ceiling designed to take weight of access panel.

F.E. Install requires sealant behind flange

Rw51 - Wall Install

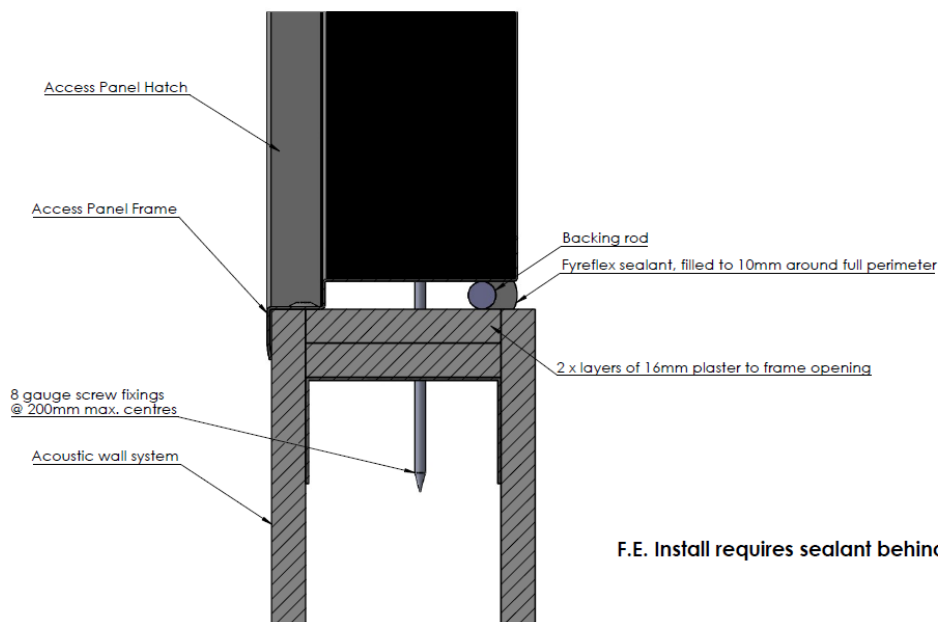

F.E. Install requires sealant behind flange



Trafalgar has developed a range of **installation videos** to assist our customers. To view these step by step install videos please go to [Trafalgar TV our YouTube Channel](#). [Subscribe](#) and you will be notified when new videos are uploaded.

Trafalgar reserves the right to change specifications without notice. Please check with your supplier at the time of order. The information contained in this brochure was correct at the time of print. E&OE. Published 11.11.2019